

# COMMUNITY CONVERSATION

P-20 Cradle-to-Career Campus at Marygrove

March 11, 2019

Marygrove  
College  
A GRADUATE SCHOOL

MARYGROVE  
CONSERVANCY

**M**  
SCHOOL OF EDUCATION  
UNIVERSITY OF MICHIGAN

  
DETROIT  
PUBLIC SCHOOLS  
COMMUNITY DISTRICT

 STARFISH  
FAMILY SERVICES

**iff** Strengthening  
nonprofits and  
the communities  
they serve.

This project is funded by The Kresge Foundation. Community engagement is facilitated by the Detroit Collaborative Design Center.



# AGENDA

- Dinner + arrival
- Partner updates
- Breakout discussions







# COMMUNITY ENGAGEMENT SUMMARY

Project Update – Detroit Collaborative Design Center



"If nothing else,  
Marygrove should  
remain a college, be a  
beacon for this area,  
and be an  
anchor of hope."

"New development  
should be reflective of  
the community so  
they know they are  
welcome."

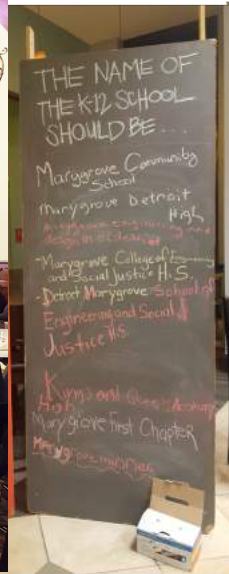

- Large community meeting
- Existing community meetings
- Focus groups
- Roaming Conversations





# Marygrove College

Project Updates – Marygrove College, Institute of Detroit Studies



*How did  
Marygrove  
get where  
it is today?*







# Marygrove College New Branding Campaign

New Mission-Driven Messages, New Logo

# Marygrove College New Branding Campaign

New Mission-  
Driven Messages,  
New Logo





# The Institute for Detroit Studies (IDS)

*Programs by, with, and about  
Detroit and Detroiters*

- **Center for Reading and Writing:**
  - Contemporary American Authors Lectures
  - Community Partnership with the Tuxedo Project
- **Arts Centered Education**
  - Institute for Music and Dance
  - Institute for Arts Infused Education
- **Defining Detroit**
  - Speakers, Research, and Fellows
  - Community Partnerships and Advocacy



*The artist, Felle, puts finishing touches on “Marvin” a new work to be featured in the Defining Detroit “Collecting Northwest” exhibit opening March 10, 2019.*



# Institute for Detroit Studies Spring 2019 Events

*These events are  
free and open to  
the public!*

## MARYGROVE COLLEGE

GRADUATE STUDIES & PROFESSIONAL DEVELOPMENT

### Coming Events from the Institute for Detroit Studies at Marygrove College



February  
11

#### "Leadership and Self-Determination in Early Twentieth-Century Black Detroit"

A presentation and book signing by Herb Boyd, City College of New York Harlem, author of *Black Detroit: A People's History of Self-Determination* (2017). 7 p.m., Monday, February 11, Madame Cadillac Hall. A *Defining Detroit* event.



March  
10

#### "A Community Collecting: Art from Northwest Detroit"

A gallery exhibition, March 10 – April 5, with an opening reception on March 10 from 3 p.m. to 6 p.m., The Gallery, fourth floor of the Liberal Arts Building. Featured artists: Monica Brown, Felle, Asia Hamilton, Donna Jackson, Chazz Miller, Darryl Smith, and Megan White. A *Defining Detroit* event.



March  
20

#### "An Evening with Desiree Cooper"

A reading and book signing by journalist and fiction writer Desiree Cooper, author of *Know the Mother* (2016). 7 p.m., Wednesday, March 20, Madame Cadillac Hall. A *Defining Detroit* event.



April  
26

#### The Lillian and Don Bauder Lecture features a reading and book signing by National Book Award recipient Elizabeth Acevedo

Author of *The Poet X* (2018), *Beastgirl and Other Origin Myths* (2016), and *With the Fire on High* (2019). 8 p.m., Friday, April 26, Madame Cadillac Hall. A *Contemporary American Authors Lecture Series* event.



May  
14

#### "Disruption in Detroit: Challenging the 1950s Prosperity Myth"

A presentation and book signing by Daniel J. Clark, Oakland University, author of *Disruption in Detroit: Autoworkers and the Elusive Postwar Boom* (2018). 7 p.m., Tuesday, May 14, Madame Cadillac Hall. A *Defining Detroit* event.







# “Generations”

By Asia Hamilton, will be featured in ***A Community Collecting: Art from Northwest Detroit***,  
March 10 – April 5, 2019 in the Marygrove Gallery, a Defining Detroit exhibit





# Early Childhood Education

Project Update – Starfish Family Services, IFF, Live6





*Strengthening families to  
create brighter futures for  
children*

Supporting families in metro Detroit  
since 1963

**StarfishFamilyServices.org**



**STARFISH**  
FAMILY SERVICES

# Early Childhood Education Center

## Project Update – Starfish Family Services



## BY THE NUMBERS



18

centers in  
Wayne County



4,000+

children served annually  
(ages 0-5 in early education  
& ages 0-17 in behavioral  
health services)



82%

of our children leave  
Starfish ready for  
Kindergarten success



450+

employees (including therapists,  
social workers, educators,  
administrators)



18

board of director members,  
representing early- and higher-  
education professionals,  
corporate and community  
leaders, Starfish parents



2,000+

volunteers, including  
individuals, corporations,  
local schools, contribute  
26,563 hours per year  
(a value of \$655,840)

**CRAIN'S  
BEST-MANAGED  
NONPROFIT**

2018 WINNER  
STARFISH FAMILY SERVICES



### Did You Know?

Starfish has the  
**largest infant mental  
health program in  
the State of Michigan**  
(\*critical to help a parent  
learn about his or her baby's  
development)

## OUR REACH



Administrative Offices



Early Childhood Education Centers



Behavioral Health Services



Home-Based Early Education  
and Behavioral Health Services



Main Office (Inkster)



# The Starfish Family Services Difference

**100%** Of our families have a voice at Starfish.

Starfish is an accredited nonprofit human services agency, recognized as a champion for children and families who have limited access to essential resources such as education, healthcare, and economic opportunities. We provide high-quality programs and support services that focus on:

- early childhood education and development (successful students),
- behavioral and physical wellness (healthy families),
- and empowered families

Through our family-centric, integrated approach, we build trusting relationships with parents and caregivers to connect them to the right resources at the right time.





Our vision is to  
deliver what every  
child in metro Detroit  
**needs and deserves:**  
the best educational  
and development  
programs in the  
country.

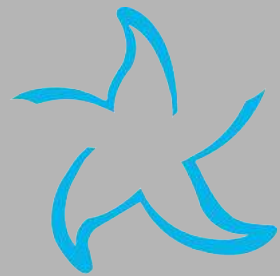

**STARFISH**  
FAMILY SERVICES







# Early Childhood Education Center

Project Update – IFF



# *How did we get here?*

- The Kresge Foundation commissioned an ECE needs assessment that identified gaps in services for children in Detroit.
- In response to the assessment report and the Kresge Early Years for Success (KEYS) initiative, Kresge committed to developing a “model” family resource center.
- Northwest Detroit was identified as an opportunity area.
- Marygrove was ultimately selected based on need and the potential to develop comprehensive services birth through 20 for neighboring residents.



# *Who is involved?*





# ECE Center Location

- Approximately 28,000 SF, single-story 12-classroom facility (driven by financial feasibility and need assessment)
- Serving approximately 142 children
- Flexible training and community space
- Health and wellness space for ECE center families
- Enrollment based on eligibility and other targeted community goals (e.g., Head Start requirements, local residents)
- Scheduled to open Fall 2020

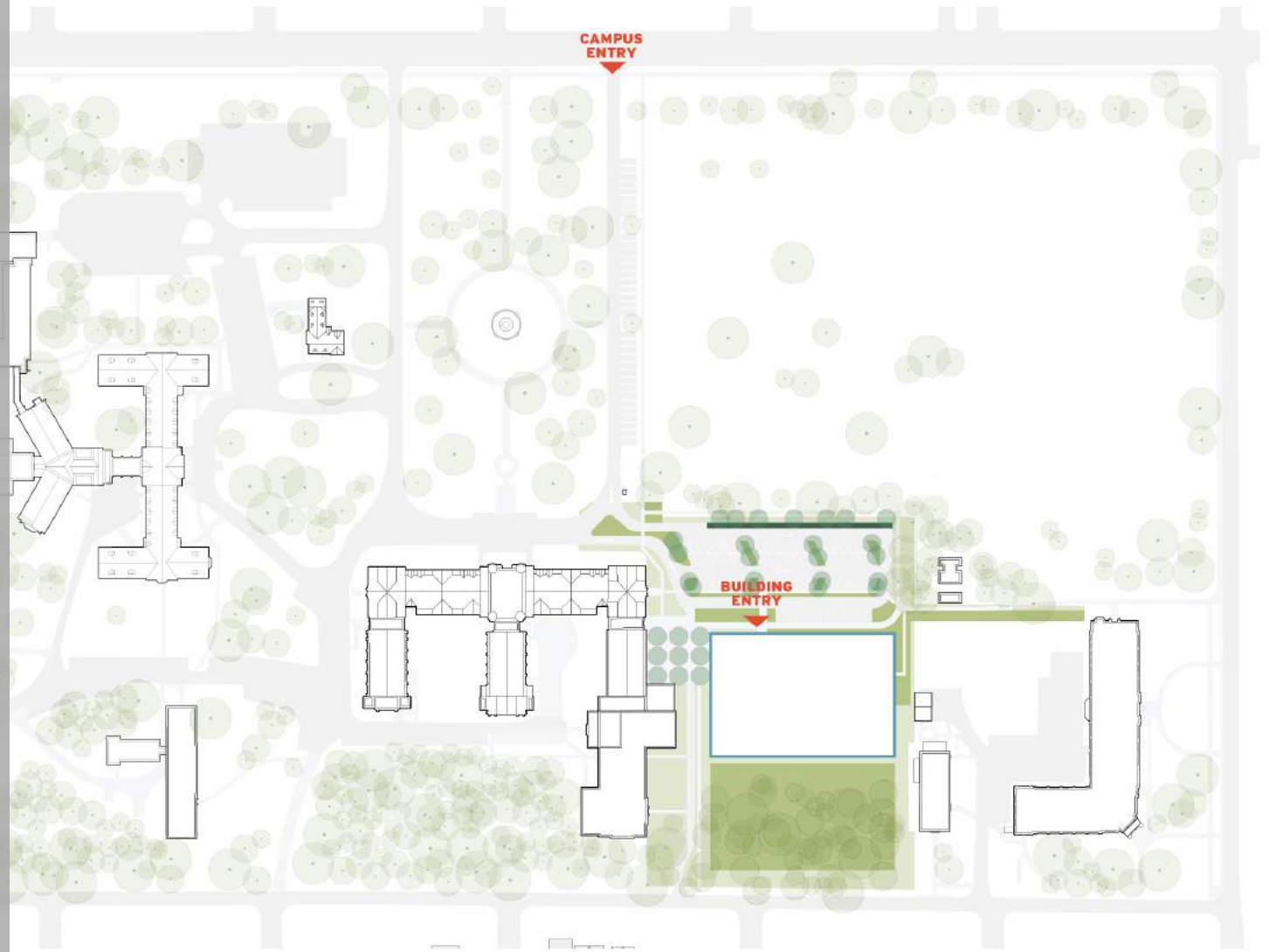





# Early Childhood Education Provider Network

Update - IFF, Live6



## Early Childhood Education (ECE) Provider Engagement Plans

- **You matter!** Current providers are essential to the existing and future service landscape.
- ECE center-based and home-based providers are running small business that need support to thrive and sustain.
- Safe environment to voice concerns, ask questions and to garner information about resources that might be beneficial to their success.
- **Next steps:** ECE focused engagement meetings – 1<sup>st</sup> planned April 2019 (subsequent meetings to follow)



Early Childhood  
Education (ECE)  
Provider Engagement  
Plans

**What do  
you need ?**







# **The Detroit P-20 System at Marygrove**

Project Updates: Detroit Public Schools Community District and University of Michigan



# Updates

## School Day/School Year

*The American Academy of Pediatrics has recommended delaying start times for middle schools and high schools to 8:30am or later.*

Research suggests that students at schools with later start times are happier and healthier:

- Improved grades and attendance
- Less likely to experience depression
- Consume less caffeine
- Less likely to be late to class
- Less likely to fall asleep in class



Students Rise. We All Rise.

# Updates



## Curriculum

*Implementing research-based, college prep, and vision-aligned curriculum*

- Broad research and input from experts on curriculum selection
- Design work to come in partnership with U-M
  - Project-based
  - Place-based
  - Problem-based
- Engineering and World Language in Year 1
- Arts programming during and after school



Students Rise. We All Rise.



# Updates

## Enrollment

### *Round 1 Application Process STATUS UPDATE*

- *Strong interest from families!*
- *37% of the students who selected Marygrove as their 1<sup>st</sup> choice live in the catchment area.*
- *March 15<sup>th</sup> decisions will be sent to families*
- *April 3-5<sup>th</sup> Pop-Up Enrollment Center @ Marygrove*
- *April 22<sup>nd</sup> Round 2 Application Window opens*
- *April 23<sup>rd</sup> Welcome Event for Enrolled Students/Families*



# Updates

## Hiring

*Teacher hiring process is underway*

- Strong pool of diverse and highly-skilled candidates
- DPSCD/U-M hiring panel
- Anticipating decisions to be finalized by March 22nd





# Updates



## Teacher Preparation

Our vision is to draw from the model of the teaching hospital to create a Teaching School—a singular school space in which every adult in the building has two goals: children’s learning and the education of excellent teaching professionals.

*Interns → Student Teachers → Residents → Detroit teaching force*

The U-M Teaching Residency will be inaugurated in the 2019-2020 school year.



Students Rise. We All Rise.

# Updates



## The Medical Model at Marygrove

*Intergenerational teaming:* Interns, student teachers, and residents work in small teams under the supervision of veteran teachers and university faculty to provide a high-quality education to Marygrove students

*Handovers and rounding:* Teams talk with one another about students' needs and development so that they may collectively share responsibility for students' learning.

*Journal club:* The staff shares the responsibility of analyzing and learning from the latest educational research to apply it to their professional practice.



Students Rise. We All Rise.



# Updates

## Wraparound Services

The Cradle-to-Career system at Marygrove is committed to serving “the whole child.”

If a student’s physiological, sociocultural, or socioemotional needs go unmet, their learning is likely to suffer.

To that end, we will draw from University of Michigan and community resources to build a coordinated network of support for students (and their families) that allows them to flourish.



## **BREAK OUT GROUPS:**

**Marygrove Campus —  
Main Dining Hall**

**Early Childhood  
Education —  
Denk Chapman**

**K-12 School —  
Brownstone**

# **LET'S TALK!**





# P-20 Cradle-to-Career Campus at Marygrove

March 11, 2019

<http://www.marygroveconservancy.org/>

# THANK YOU!!!

Marygrove  
College  
A GRADUATE SCHOOL

MARYGROVE  
CONSERVANCY

**M**  
SCHOOL OF EDUCATION  
UNIVERSITY OF MICHIGAN

  
DETROIT  
PUBLIC SCHOOLS  
COMMUNITY DISTRICT

 STARFISH  
FAMILY SERVICES

**iff** Strengthening  
nonprofits and  
the communities  
they serve.

This project is funded by The Kresge Foundation. Community engagement is facilitated by the Detroit Collaborative Design Center.